

KEY



Proposed Conversion of Existing Zebra Crossing to Puffin Crossing



Proposed Prohibition of Right Turn Movement

Brighton College

Main Entrance

EASTERN ROAD

COLLEGE ROAD

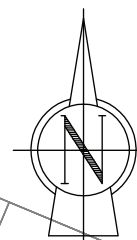
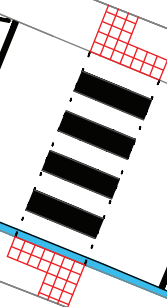

Rev	Revision details	
	Signed	Date
Drawn:	D Abbott	April 2010
Surveyed:	surveyed	-
Checked:		
Approved:		

File/Acad ref: S:\Env\Rd Schemes\Current Projects\Safer Routes\Queen's Pk



Project Name
**Queen's Park School
Safer Routes to School Scheme**

Drawing Title
**Eastern Road/Brighton College
Conversion of Zebra Crossing
to Puffin Crossing**

Drawing No .dwg	Scale 1/200 @ A3	Rev
--------------------	---------------------	-----

Reproduced from the Ordnance Survey mapping with the permission of the Controller of H.M. Stationary Office. © Crown copyright. Unauthorised reproduction infringes Crown copyright and may lead to prosecution or Civil Proceedings.
Brighton & Hove City Council, Licence: 100020999, 2010.

181

